

EDUCATIONAL SUPPORT SPACES AREA PER LEARNER / STAFF		
	SQM	PROPOSED
CLASSROOMS	3.55M²	485QM x 11
GRADE R FACILITY	2.5M²	60SQM x 1
SICK ROOM		8SQM
STORE ROOM		8SQM
KITCHEN		42SQM
NEW DEDICATED COVERED AREA		50SQM
PARKING BAYS		12 BAYS
STAFF ROOM	3.5M²	42SQM
HEAD OF DEPARTMENT AND SUPPORTING SPACES		48SQM

KEY:	
<div></div>	PROPOSED PREFABRICATED BUILDING
<div></div>	CLAY BRICK PAVED PEDESTRIAN WALKWAY
<div></div>	NEW CONCRETE INTERLOCKING PAVED PARKING AREA
<div></div>	CONCRETE VERANDA
<div></div>	EXISTING FENCE TO REMAIN
<div></div>	PROPOSED FENCE

SANITATION REQUIREMENTS FOR PUBLIC SCHOOLS		
	NEED	PROPOSED
GIRLS WC	4	4
GIRLS WHB	2	2
BOYS WC	2	2
BOYS WHB	2	2
BOYS URINALS	2	2
DISABLED WC AND WHB	1	1
FEMALE STAFF WC	0	1
FEMALE STAFF WHB	0	1
MALE STAFF WC	0	1
MALE STAFF WHB	0	1
MALE STAFF URINALS	0	1

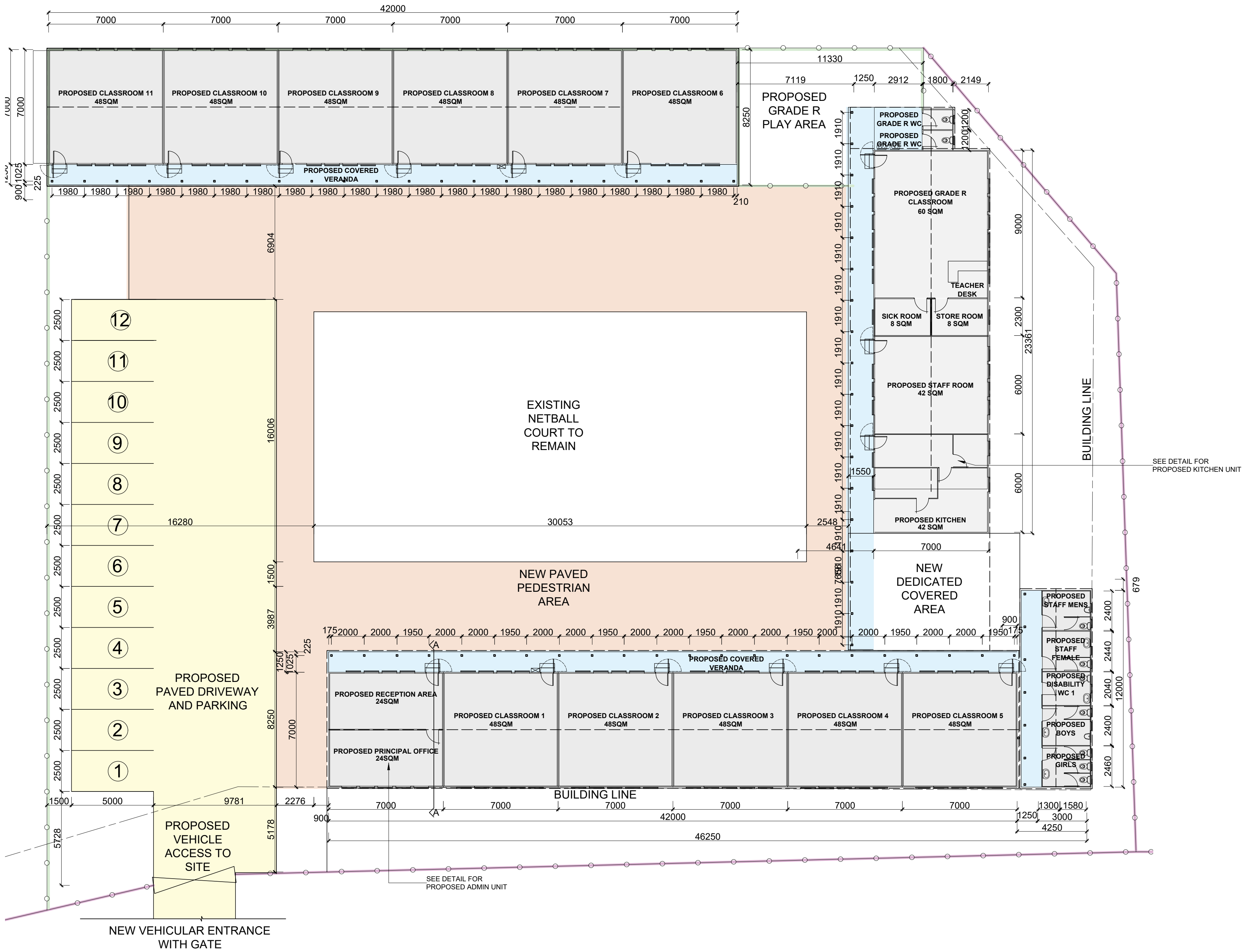

PROPOSED DECANTING FLOOR PLAN
SCALE 1/200



SACAP REGISTRATION
DEBBIE WINTERMEYER
ARCHITECT
30 JUNE 2006
REGISTRATION NUMBER : 7517

THE
WORKPLACE
AGENCY

121 VILBERS ROAD
WILMERSBURG
7517
TEL: 021 551 4390
CELL: 082 745 1265
EMAIL: debbie@theworkplaceagency.co.za

BRYAN WINTERMEYER
ARCHITECT
14 MAY 2002
REGISTRATION NUMBER : 6591

121 VILBERS ROAD
WILMERSBURG
7517
TEL: 021 551 4390
CELL: 082 745 1265
EMAIL: bryan@theworkplaceagency.co.za

REVISIONS

No.	Description	Date
00	ISSUED TO CLIENT FOR INFORMATION	19-07-23

FOR INFORMATION

TOWN PLANNING PARAMETERS		
	Limitation/ Requirement	Actual Provided
Zoning		
Stand Area:		
Erf Area:		
Coverage		
F.S.I. and Density		
Habitable Rooms		
Parking		
Height		
Open Space		
Building Lines		
Unit (Orientation, Size, Design)		
Boundary Wall		
Effect on Neighbouring Erven		
Optimum Access		
Circ. Phasing		
General Quality		
Aesthetics		
Occupancy Classification		

DESIGN DRAWING APPROVED AND SIGNED
BY DULY AUTHORISED REPRESENTATIVES

CLIENT
DEVELOPMENT BANK OF SOUTH AFRICA
Contact Person: Mr. Richard Mulyavavuti
Address: 1250 Lever Road, Headway Hill, Midrand, JOHANNESBURG, 1685
Telephone: +27 (11) 315 - 3488
Cell: 082 745 1265
E-mail: richardm3@dbsa.org

Signature: _____ Date: 19 July 2023

PROJECT ARCHITECTS & PROJECT MANAGERS
THE WORKPLACE DEVELOPMENT FIRM cc.
Contact Person: Mr. Debbie Wintermeyer
Address: 121 Vilbers Road, Wilmer, Port Elizabeth, 6065
Telephone: 041 581 4390
Cell: 079 803 5906
E-mail: debbie@theworkplaceagency.co.za

Name: MR BRYAN WINTERMEYER SACAP No: 6591
SAIA No: -

Signature: *B. Wintermeyer* Date: 19 July 2023

Practice: The Workplace Agency SACAP No: -
SAIA No: PW 4693

COPYRIGHT NOTES:

These drawings, all the content and information provided are the property of The Workplace Agency. The drawings and content are owned by The Workplace Agency, and are the protected by copyright and other intellectual property laws. All rights not expressly granted are reserved. The drawings are issued on the condition that it is not copied, reproduced, retained or disclosed to any unauthorized person, either wholly or in part without the written consent of The Workplace Agency.

The Professional shall not be liable (whether in contract or in delicate) to the client or any other party whatsoever as a result of the use of the consulting engineers' designs, drawings and specifications in any project or works other than those for which they are intended, detailed in this agreement, and the client hereby indemnifies the professional against any claim which may be against him by any party whatsoever in any way arising out of the unauthorized use of such documentation for such other purpose as aforesaid.

IMPORTANT GENERAL NOTICES

All levels, dimensions, depths of excavation, heights of plinths, number of steps and sizes of foundations to be determined on site. Read figured dimensions in preference to scaling drawings prepared on surface examination only.

These drawings are to be read in conjunction with structural engineer's, civil engineer's, mechanical engineer's or plumbing consultants drawings where specified.

All work and material used to comply with SABS standards and NATIONAL BUILDING REGULATIONS ACT 103 of 1977 and amendments thereto as well as the by-laws of the relevant local authority.

ALL WORK TO BE IN STRICT COMPLIANCE WITH SANS 10400 AND SANS 204.

All new construction HEALTH AND SAFETY Regulations to be strictly complied to. A comprehensive Health & Safety Plan to be submitted to the Principal Agent/ Project Manager for review and monitoring.

PROJECT

NOBANTU JUNIOR PRIMARY SCHOOL
BUFFALO CITY
P9011591

PROPOSED DECANTING FLOOR PLAN

Project number 202213
Date 19 JULY 2023
Drawn by CG
Checked by BW

MS - 101 - R01

Scale 1:200 at A1